

Design Title :  
Revision Level :  
Approved by :  
Designer :  
Company :  
Address :  
E-Mail :  
Phone :  
Date : 2020-08-15

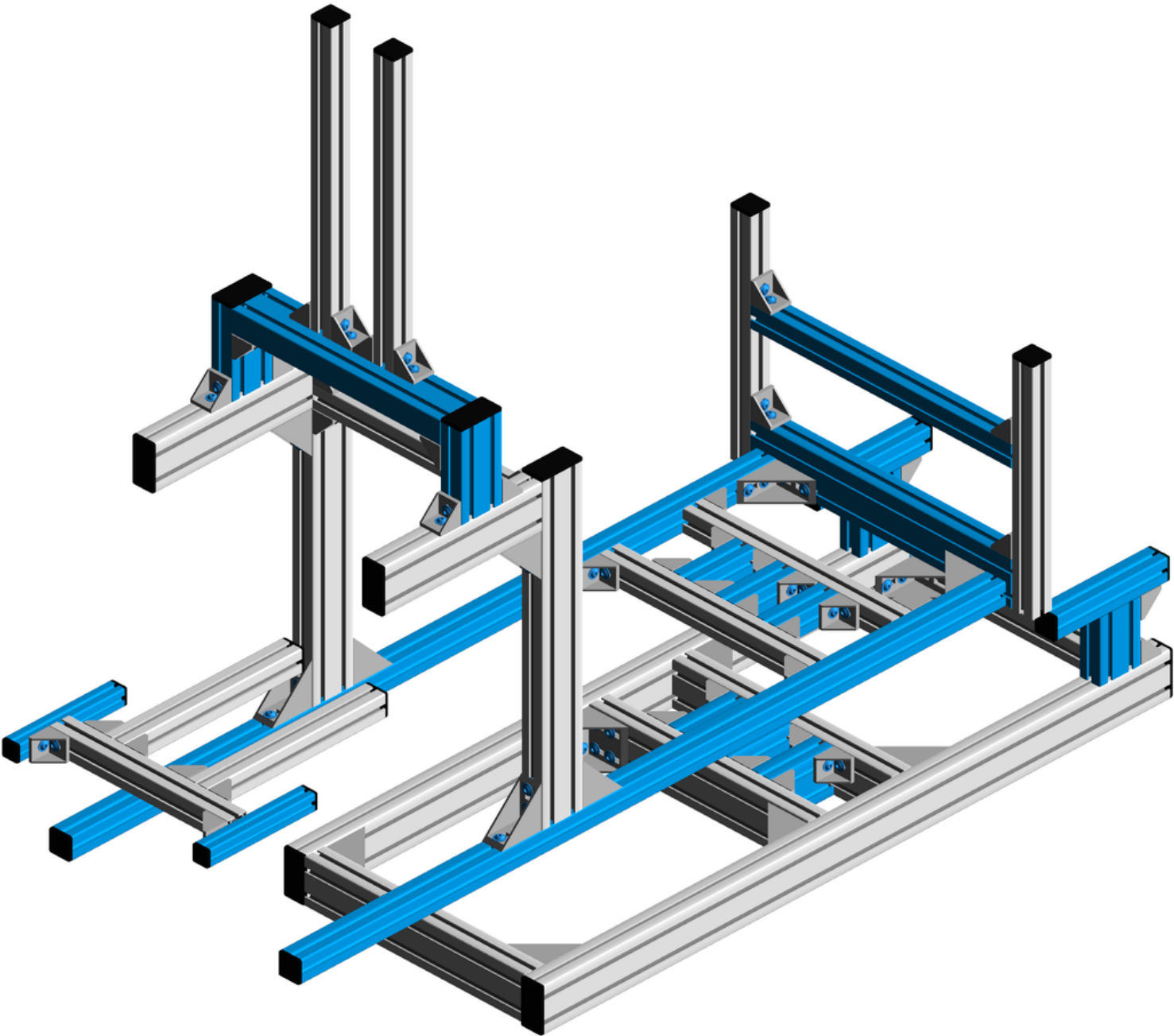

Bill of materials

Pos	Article-No	Description	Units	Qty	Each €	Price €
1	1.11.030030.43LP-A00A00/200	Profile 30x30, 4F, light, plain	MM	2	3.41	6.81
2	1.11.040040.43LP-A00A00/420	Profile 40x40, 4E, light, plain	MM	1	6.93	6.93
3	1.11.040040.43LP-A00A00/210	Profile 40x40, 4E, light, plain	MM	2	4.22	8.43
4	1.11.040040.43LP-A00A00/405	Profile 40x40, 4E, light, plain	MM	2	6.74	13.48
5	1.11.040040.43LP-A00A00/1350	Profile 40x40, 4E, light, plain	MM	2	18.96	37.93
6	1.11.040040.43LP-A00A00/120	Profile 40x40, 4E, light, plain	MM	3	3.05	9.16
7	1.11.040040.43LP-A00A00/340	Profile 40x40, 4E, light, plain	MM	3	5.90	17.69
8	1.11.040040.43LP-A00A00/400	Profile 40x40, 4E, light, plain	MM	3	6.67	20.02
9	1.11.040040.43LP-A00A00/500	Profile 40x40, 4E, light, plain	MM	3	7.97	23.90
10	1.11.040080.44LBP-F00F00/400	Profile 40x80, 4E, light, B, plain	MM	1	14.08	14.08
11	1.11.040080.64LP-F00F00/500	Profile 40x80, 6E, light, plain	MM	1	14.55	14.55
12	1.11.040080.64LP-F00F00/110	Profile 40x80, 6E, light, plain	MM	2	4.99	9.99
13	1.11.040080.64LP-F00F00/150	Profile 40x80, 6E, light, plain	MM	2	5.97	11.95
14	1.11.040080.64LP-F00F00/300	Profile 40x80, 6E, light, plain	MM	2	9.65	19.30
15	1.11.040080.64LP-F00F00/560	Profile 40x80, 6E, light, plain	MM	2	16.02	32.04
16	1.11.040080.64LP-F00F00/1200	Profile 40x80, 6E, light, plain	MM	2	31.70	63.39
17	1.11.040080.64LP-F00F00/120	Profile 40x80, 6E, light, plain	MM	3	5.24	15.72
18	1.11.040080.64LP-F00F00/420	Profile 40x80, 6E, light, plain	MM	3	12.59	37.77
19	1.42.20303.2	Cover cap 30x30, black	EA	4	0.77	3.08
20	1.42.20404.2	Cover cap 40x40, dia: 12, black	EA	12	0.96	11.52
21	1.42.20408.2	Cover cap 40x80, black	EA	10	1.43	14.30
22	1.46.204.3876.1	Angle GD-Zn, 38x76, natural	EA	10	4.89	48.90
23	1.46.204.4039.1	Angle GD-Zn, 40x39, natural	EA	54	2.13	115.02
24	1.46.204.7476.1	Angle GD-Zn, 74x76, natural	EA	6	8.03	48.18
25	0.63.WN7381.08012	Round head flange screw, M8x12, WN7381	EA	2	0.18	0.36
26	0.63.WN7381.08016	Round head flange screw, M8x16, WN7381	EA	194	0.18	34.92
27	1.32.4EM8	T-Nut for subsequent insertion, w. spring E, M8	EA	194	1.13	219.22
28	1.32.4FM8	T-Nut for subsequent insertion, w. spring F, M8	EA	2	1.13	2.26
29	1.46.204.3876A	Cover cap for angle GD-Zn, 38x76	EA	10	1.25	12.50
30	1.46.204.4039A	Cover cap for angle GD-Zn, 40x39	EA	54	0.67	36.18
31	1.46.204.7476A	Cover cap for angle GD-Zn, 74x76	EA	6	2.30	13.80

Total Weight:

49.46 kg (109.05 lbs)

Total (EURO):

€ 923.38

\* The price indicated above, does not include assembly, packaging, taxes and transport.

## Isometric view

Some accessories may not be shown

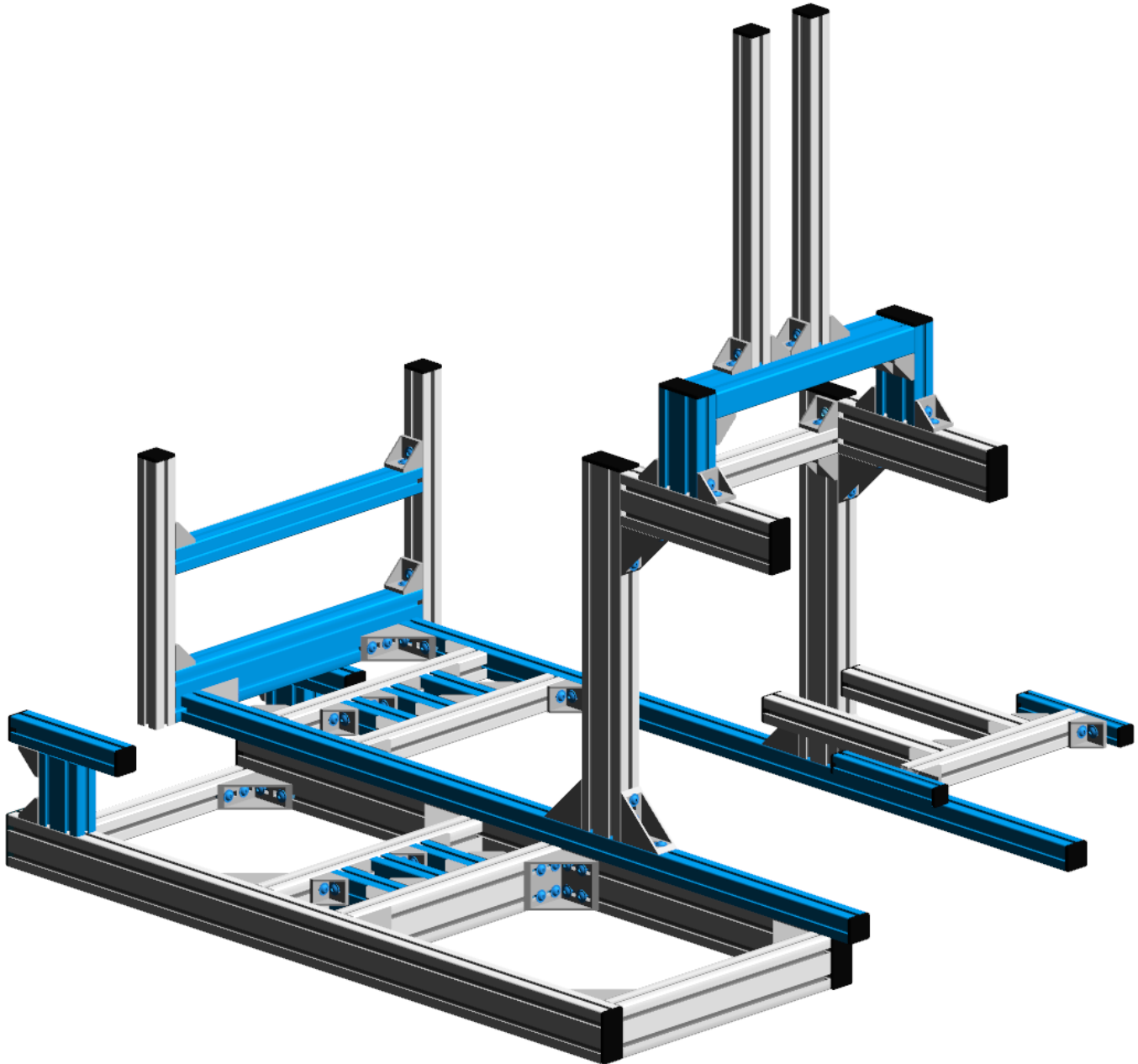

Multiview

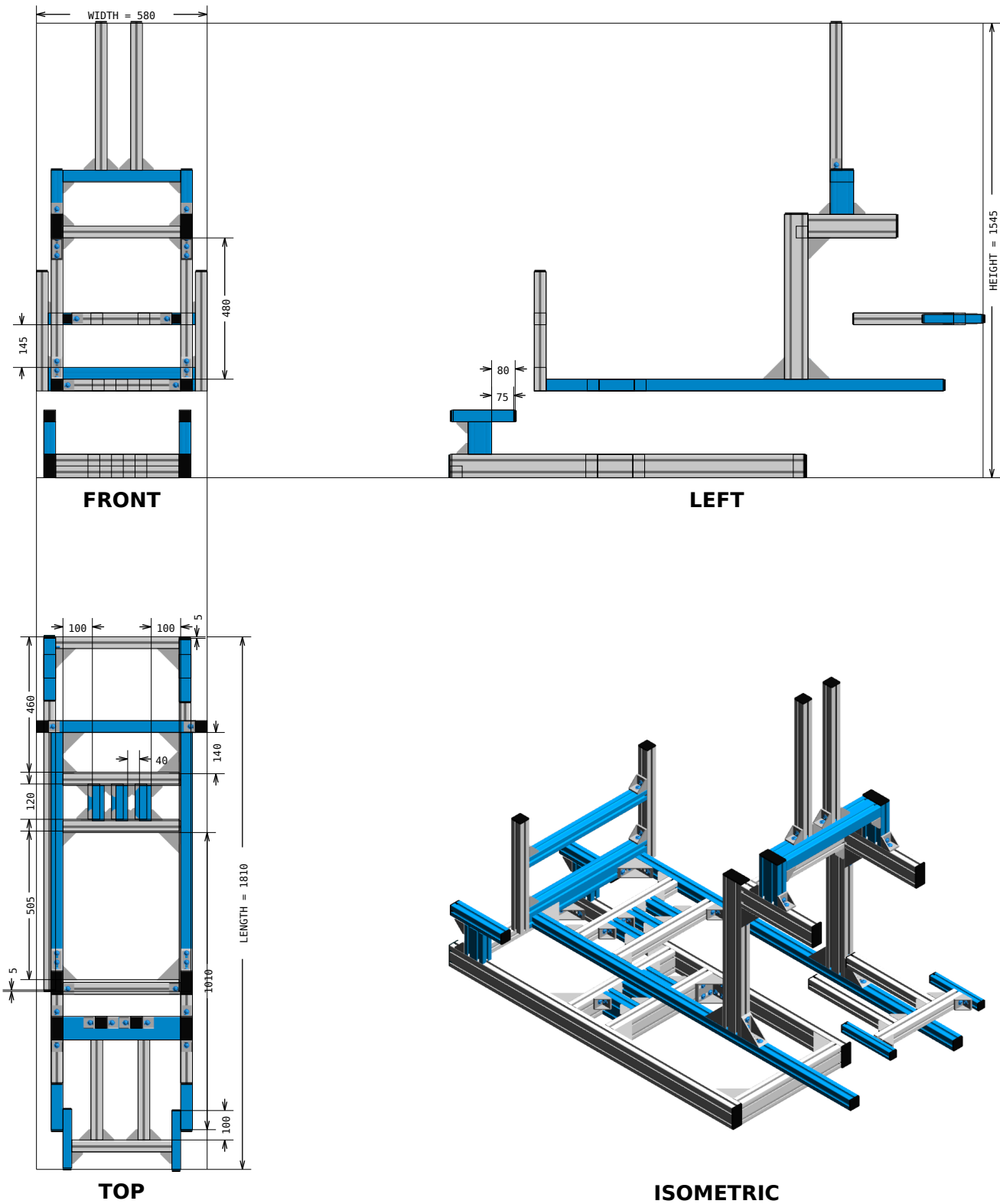

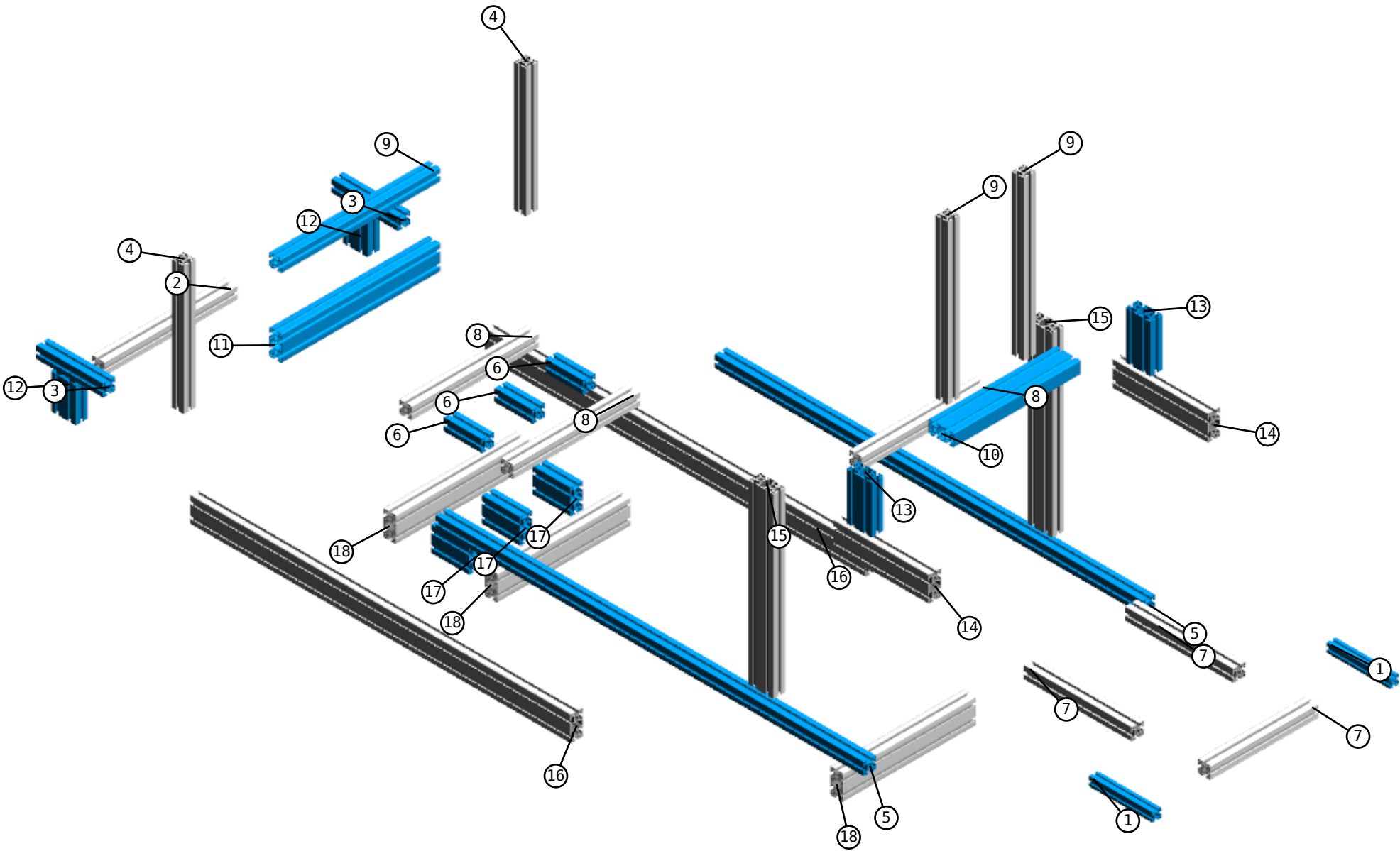

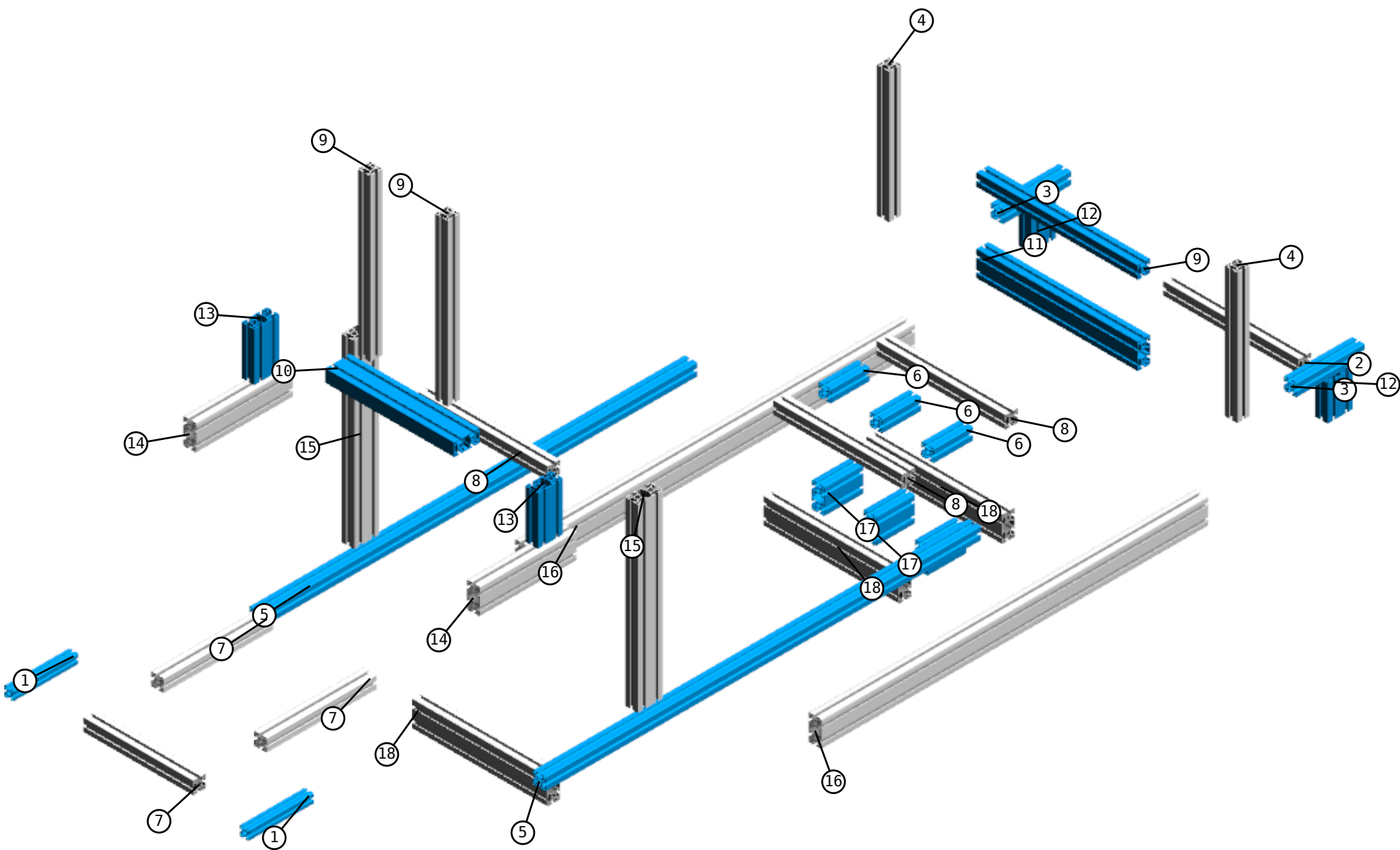

# Assembly List

Pos	Article-No	Description	Related parts	Qty
22	1.46.204.3876.1	Angle GD-Zn, 38x76, natural	1.32.4EM8, T-Nut for subsequent insertion, w. spring E, M8	40
			1.46.204.3876A, Cover cap for angle GD-Zn, 38x76	10
			0.63.WN7381.08016, Round head flange screw, M8x16, WN7381	40
23	1.46.204.4039.1	Angle GD-Zn, 40x39, natural	1.32.4EM8, T-Nut for subsequent insertion, w. spring E, M8	106
			1.32.4FM8, T-Nut for subsequent insertion, w. spring F, M8	2
			0.63.WN7381.08016, Round head flange screw, M8x16, WN7381	106
			1.46.204.4039A, Cover cap for angle GD-Zn, 40x39	54
			0.63.WN7381.08012, Round head flange screw, M8x12, WN7381	2
24	1.46.204.7476.1	Angle GD-Zn, 74x76, natural	1.32.4EM8, T-Nut for subsequent insertion, w. spring E, M8	48
			1.46.204.7476A, Cover cap for angle GD-Zn, 74x76	6
			0.63.WN7381.08016, Round head flange screw, M8x16, WN7381	48

# Profile machining details

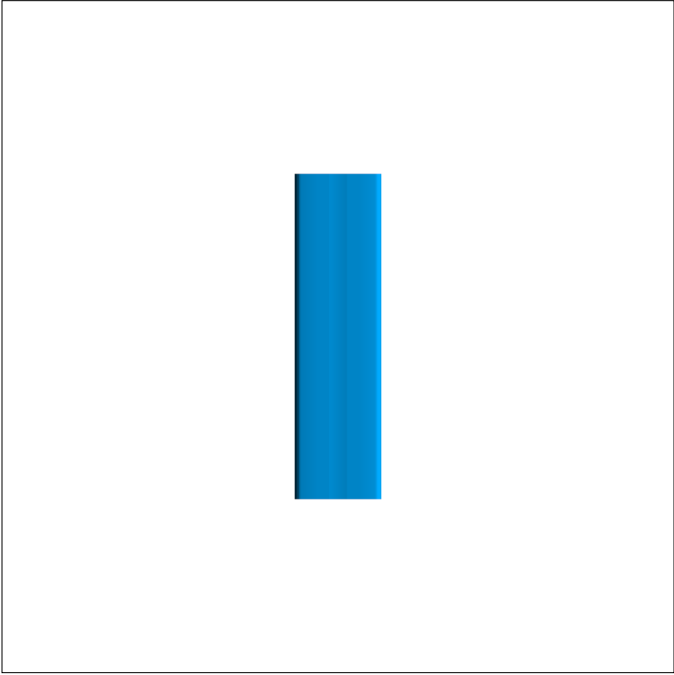

**DRAWING None, Pos 13**  
**SIDE 1, bar length: 150.0 mm**

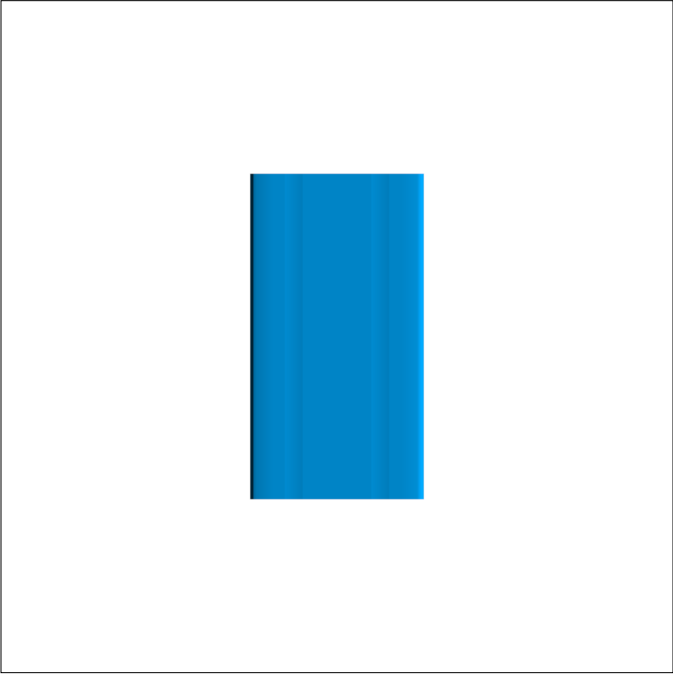

**DRAWING None, Pos 13**  
**SIDE 2**

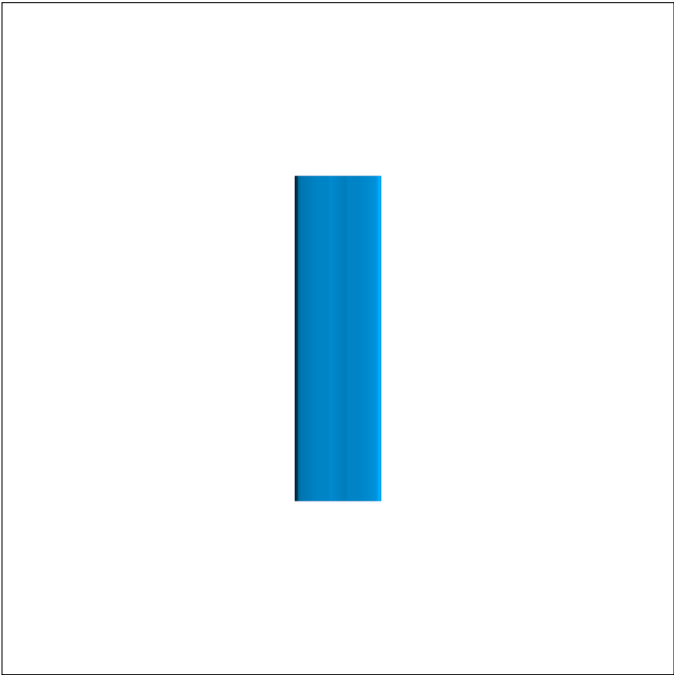

**DRAWING None, Pos 13**  
**SIDE 3**

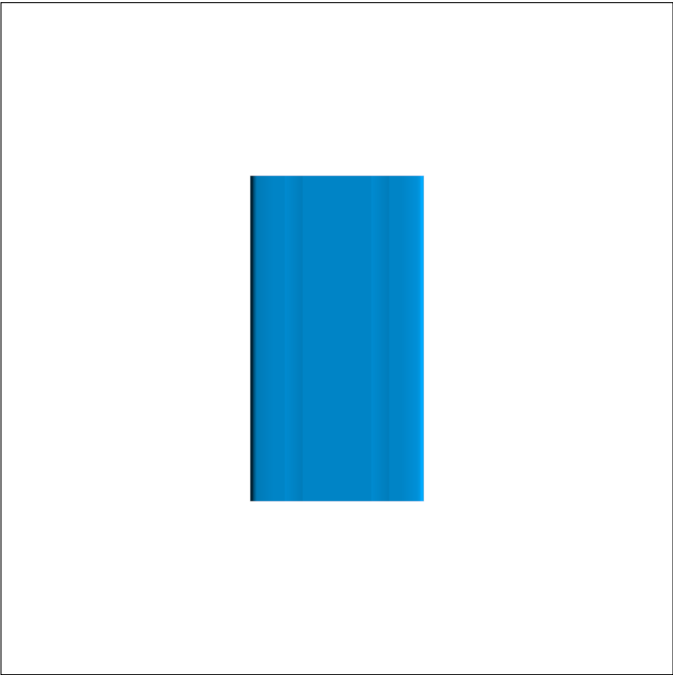





**DRAWING None, Pos 13**  
**SIDE 4**

← Profile "left end" is always at the bottom of the drawing. All dimensions are from "left".

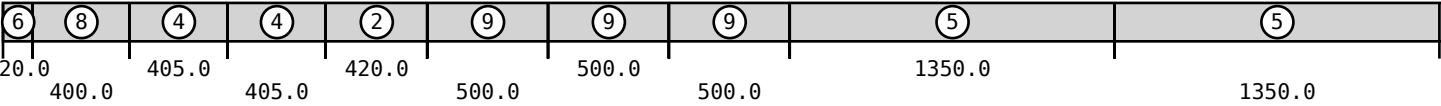

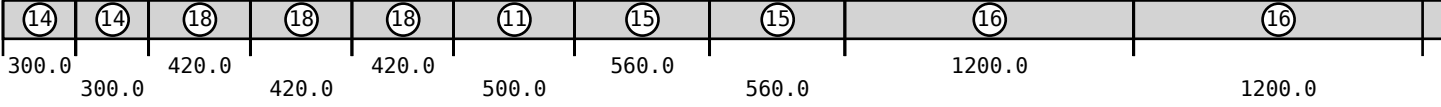
# Suggested profile cuts (incl. kerf: 3.5 mm)

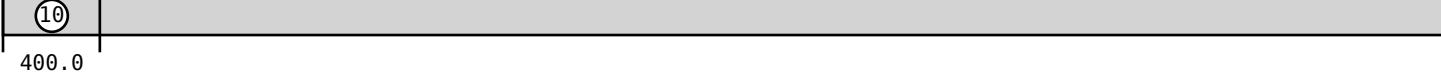
Article-No	Cuts	Waste (mm)
1.11.040040.43LP		15.0 mm
		3488.5 mm
1.11.040080.64LP		85.0 mm
		5095.5 mm
1.11.030030.43LP		5593.0 mm
1.11.040080.44LBP		5596.5 mm

# Assembly hints

ACCESSORY	1.32.4EM8	T-Nut for subsequent insertion, w. spring E, M8
	1.32.4FM8	T-Nut for subsequent insertion, w. spring F, M8



Fixing with leaf spring

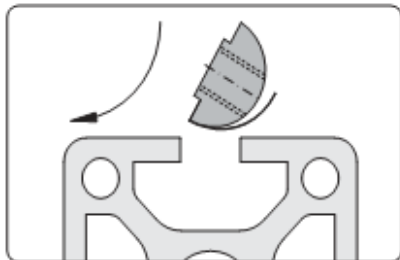

Insert front-sided and rotate

**Application**  
Fastening element for screw-type connections

**Technical data**  
Design steel:  
• material: steel  
• surface: galvanised  
Design stainless:  
• material: stainless steel 1.4305  
• surface: pickled and passivated  
max. moment of torque:  $M_{A, max}$

These t-nuts are easily inserted into assembled frames

# Assembly hints

ACCESSORY	1.46.204.3876.1	Angle GD-Zn, 38x76, natural
	1.46.204.4039.1	Angle GD-Zn, 40x39, natural
	1.46.204.7476.1	Angle GD-Zn, 74x76, natural
	1.46.204.3876A	Cover cap for angle GD-Zn, 38x76
	1.46.204.4039A	Cover cap for angle GD-Zn, 40x39
	1.46.204.7476A	Cover cap for angle GD-Zn, 74x76

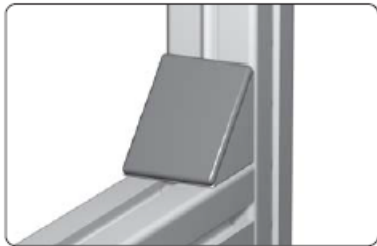

**Application**  
For supporting profiles and mounting various machine components

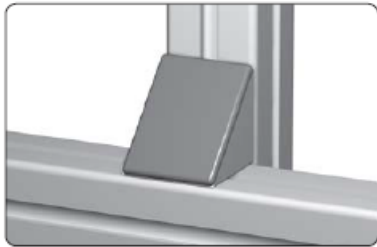

**Technical data**  
material:  
• angle: GD-Zn  
• cover cap: PA-GK 30  
• T-slot nut: steel, galvanised  
• screw: steel, galvanised  
surface: natural or aluminium coloured powder-coated

For mounting cross to the slot the noses can be broken off

These corner brackets or gussets can be used to reinforce or completely replace the Universal or Standard profile connector, make sure to choose the kit appropriate for your slot type H, F or E. These parts could also be used to mount additional parts and hardware.