

Material : Motor Arms - 2x 25x5mm Flat Bar.- 70 long
Motor Mount Supports - 2x 50x3mm Flat Bar - 40 long

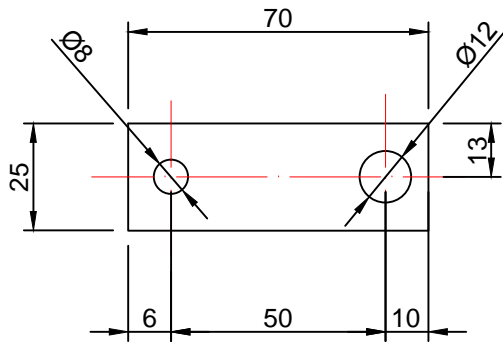

Motor Arm
1xLHS 1xRHS

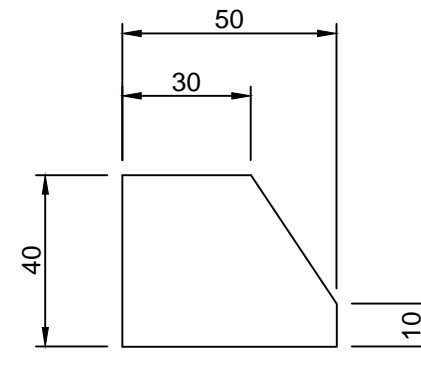

Motor Mount Support
1xLHS 1xRHS

Notes:

Not to Scale

All dimensions in mm

For holing in Arm 12mm is to suit shaft for motor &
8mm to suit rod end attachment, please change if
yours is a different size.

**Motor Mount
Accessories**